



CERTIFICATE OF  
COMPLETION

AWARDED TO

Preston Hemphill

Of the Memphis Police Department

IN RECOGNITION OF YOUR SUCCESSFUL COMPLETION OF  
TASER X2 CEW V.22 USER  
CERTIFICATION COURSE  
TRAINING CERTIFICATE

ISSUED September 16, 2022

Instructor: M. Hannah #1769

Instructor: B. Knowles #12141



**TASER Training Version 22**

*This document is not needed if class registered in Axon Academy (email [training@taser.com](mailto:training@taser.com) for details)*

**TASER® Conducted Energy Weapon (CEW)  
New User Applicant Certification Form**

Effective Date: June 22, 2020

**Which CEWs were you certified on (Check all that apply):** ☐ M26 ☐ X26 ☐ X26P ☒ X2 ☐ X3

Name: Hemphill, Preston Agency: Memphis Police Department  
Email: preston.hemphill@memphistn.gov Phone: 901-636-4500  
Address/State/Zip: 3840 Ridgeway Rd, TN, 38115 Ridgeway Station

By signing below, I hereby acknowledge receipt of TASER's Product Warnings. I understand that I must read and understand these warnings PRIOR to participating in any hands-on CEW drills required by this certification Course.

Student Signature: (Required) [Signature] 13941

**TASER Instructor Use Only**

Instructor is required to verify that applicant has successfully completed all CEW User Certification requirements

- ☒ Test must be completed with score of 90% (remediate as needed)  
☐ N/A Completed TASER CEW online course
- ☒ Review entire Version 22 User Certification Course PowerPoint Presentation(s) & training bulletins  
(if applicable) ☐ N/A Completed TASER CEW online course
- ☒ Demonstrate safe handling of CEW to include: proper finger positioning, aiming and deploying at preferred target area and while loading / unloading
- ☒ Deploy a minimum of 2 live cartridges (for each weapon certification), placing both probes in preferred target zones
- ☒ Perform a proper warning ARC (Safety warning: remove cartridge from X26P before conducting Arc warning)
- ☒ (X2 & X3) Utilize the ARC switch to re-energize deployed probes

I hereby certify that the above-named applicant has satisfactorily completed all components of the TASER User Certification training program and is hereby certified as a user of this system for one year.

Attested by Certifying Instructor: K Boulton #12580 [Signature]  
(Print Name) (Signature)

Date: 9-16-22 Location of Training: F.T.U

***This form is for internal use only  
Please do not send to the TASER Training Department***

PowerPoint is a trademark of Microsoft Corporation

Axon, X2, X3, X26, and TASER are trademarks of Axon Enterprise, Inc., some of which are registered in the US and other countries. For more information, visit [www.axon.com/legal](http://www.axon.com/legal). All rights reserved © 2020 Axon Enterprise, Inc.

Version 22

**TASER® Conducted Energy Weapons (CEWs)**  
**Part 1: User Certification Test**

Name: Hemphill, Preston New Certification ☒ / Recertification ☐  
Agency: Memphis Police  
Training Date: 9-16-22 Location: FTU

1. The Nervous System consists of the following:
  - a) Central Nervous System - Command Center (brain and spinal cord)
  - b) Motor Nervous System - Carries commands from the brain to muscles (NMI systems affect BOTH the Sensory and Motor Nerves)
  - c) Sensory Nervous System - Brings information into the brain (affected by stun systems)
  - ☒ d) All of the above
2. In considering the use of a CEW:
  - a) Do not use for verbal defiance
  - b) Do not use for belligerence
  - c) Do not use for punishment
  - d) Do not use for horse play
  - ☒ e) All of the above
3. The preferred target areas for CEW exposure are:
  - a) Lower center mass (below chest or area of the heart) and legs for front exposure
  - b) Below the neck area for back exposures
  - c) Anywhere on the person's body
  - d) a and b
  - ☒ e) a and b (with the back being the most preferred area)
4. As with any use of force, the longer the CEW exposure the greater the risk of potential cumulative physiologic, metabolic, and other effects.
  - ☒ a) True
  - b) False
5. The officer should avoid intentionally targeting the CEW on sensitive areas of the body such as the head, throat, breast, chest (area of the heart), genitals, or known pre-existing injury areas without legal justification.
  - ☒ a) True
  - b) False
6. Probe deployments are more desirable/effective than drive stuns (other than 3-point deployments).
  - ☒ a) True
  - b) False
7. The further a CEW exposure is away from the heart and the fewer CEW cycles applied the greater the safety margin for the CEW affecting the heart.
  - ☒ a) True
  - b) False

17. During CEW voluntary exposures which of the following are required safety rules?
  - a) Always use two spotters when volunteer is standing
  - b) Spotters must hold volunteers closely under the armpit to stabilize the shoulder and upper arm
  - c) The volunteer should be safely supported and carefully lowered to the ground
  - ☒ d) All of the above
18. The handheld electronic weapons manufactured by Axon (formerly TASER) are referred to as:
  - a) Electronic Control Weapons
  - b) Shock devices
  - ☒ c) Conducted Energy Weapons
  - d) Conducted Energy Devices
19. A single CEW trigger pull and release discharges an electrical charge for a:
  - a) 10 second cycle
  - ☒ b) 5 second cycle
  - c) 4 second cycle
  - d) The cycle always stops as soon as the trigger is released
20. A pre-shift 5-second CEW spark/functionality test is recommended to:
  - ☒ a) Ensure the CEW is sparking and functioning properly
  - b) Create muscle memory
  - c) Practice drawing and holstering the CEW
  - d) Teach proper CEW safety
21. TASER Training does not set use-of-force policies, general orders, or procedures
  - ☒ a) True
  - b) False
22. Activated CEWs can ignite:
  - a) Gasoline and gasoline vapors
  - b) Butane
  - c) Some personal defense sprays
  - d) Some hair sprays or gels
  - ☒ e) All of the above
23. A CEW application on a person can cause physiologic or metabolic effects, including, but not limited to, changes in:
  - a) Blood Chemistry
  - b) Heart rate, and rhythm
  - c) Blood pressure
  - d) Respiration
  - e) Adrenaline and Stress hormones
  - ☒ f) All of the above

Version 22

**TASER® Conducted Energy Weapons (CEWs)**  
**Part 2: X2 Certification Test**

Name: Hemphill, Preston New Certification ☒ / Recertification ☐

Agency: Memphis Police

Training Date: 9-16-22 Location: FTU

1. The ARC switch can be used to:
  - A. Initiate the warning arc
  - B. Toggle between cartridges
  - C. Re-energize deployed cartridges
  - ☒ D. All of the above
2. A warning arc can be displayed on the X2 without discharging loaded cartridges.
  - ☒ A. True
  - B. False
3. The Automatic-Shutdown Performance Power Magazine (APPM) automatically stops the TASER cycle after 5 seconds even if the trigger is held down.
  - ☒ A. True
  - B. False
4. An X2 set to semi-automatic mode will advance to the next live cartridge once a cartridge is deployed and the trigger is released. A second trigger pull will discharge the second cartridge.
  - ☒ A. True
  - B. False
5. If an X2 has a PPM, TPPM, or TASER Cam (without auto-shutdown) for a power source, and the trigger is held down beyond the 5-second cycle, the X2 will continue to cycle until the trigger is released or the battery (PPM) drains.
  - ☒ A. True
  - B. False

6.	Central Information Display	<u>A</u>	14.	ARC Switch	<u>E</u>
7.	Cartridge Bay #1	<u>K</u>	15.	Dual LASERs	<u>I</u>
8.	Front Sight	<u>O</u>	16.	Selector Switch	<u>M</u>
9.	Safety Switch	<u>B</u>	17.	Performance Power Magazine	<u>C</u>
10.	Cartridge Bay #2	<u>G</u>	18.	LED Flashlight	<u>J</u>
11.	Power Accessory Interface	<u>L</u>	19.	Rear Sight	<u>N</u>
12.	Trigger	<u>F</u>	20.	PPM Release Button	<u>D</u>
13.	Cartridge Eject Button	<u>H</u>			

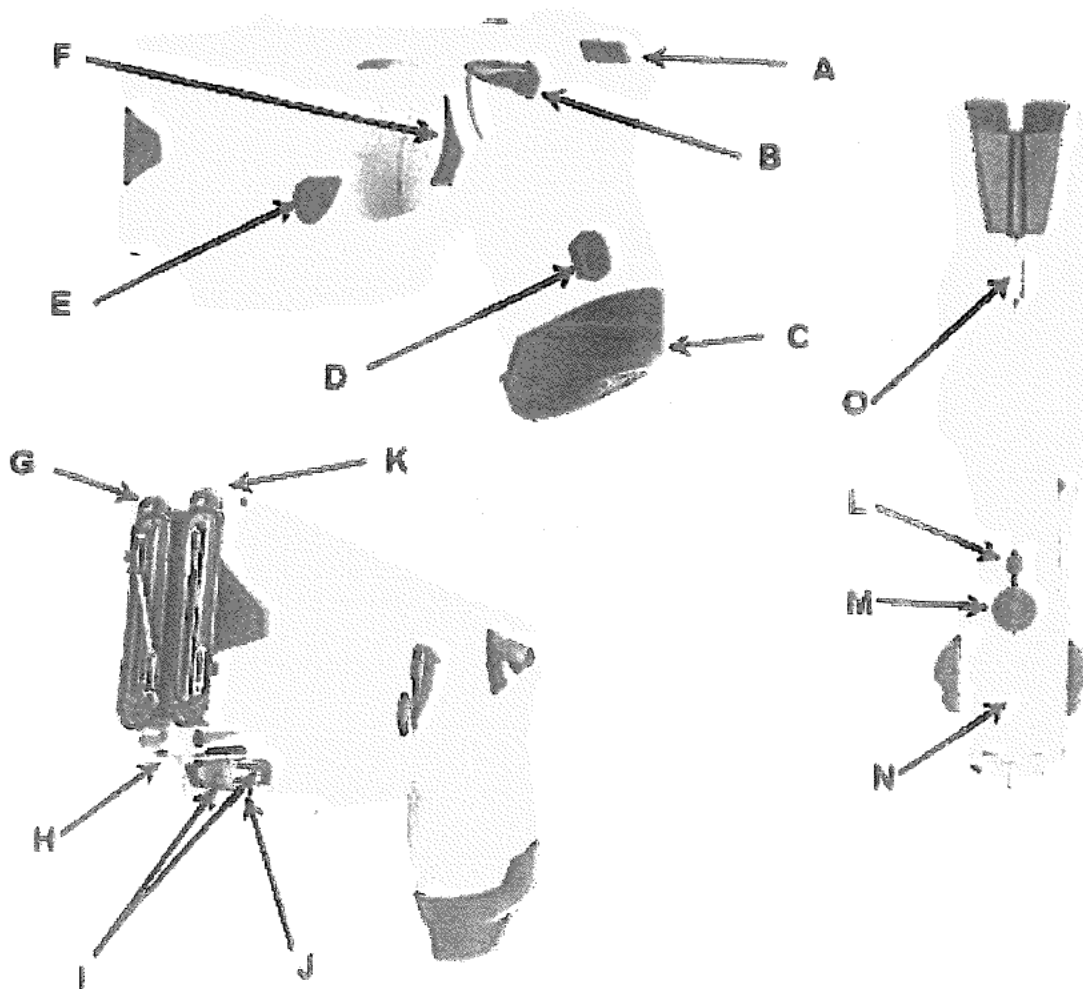

Version 22 TASER® CEWs Part 2: X2 Certification Test

Please Write Legibly



FIREARMS TRAINING UNIT  
SPECIALIZED TRAINING  
SIGN-IN SHEET



TRAINING: NEW TASKER

DATE: 9/16/2022

	IBMR	LAST NAME, FIRST	SEX	RACE	RANK	ASSIGNMENT / AGENCY
1.	11460	Clements, James	M	W	PII	Tillman - Charlie MPD
2.	11707	TALFORD, BRANDON	M	B	PII	MT. MARIAN BRAVO / MPD
3.	13336	Smothers, Tyler	M	W	PII	N. Main A / MPD
4.	14392	TROSE, Jeff	M	W	PII	CRUMP C / MPD
5.	14635	GARLAND, Aron	M	W	PII	Austin Paddy AREA
6.	13941	Hemphill, Preston	M	W	PII	Ridgeway / MPD
7.	14405	Washington, Ashley	F	B	PII	Raines Alpha / MPD
8.	13949	Tieney, Ian	M	W	PII	APS Alpha
9.	14161	Fair, Colton	M	W	PII	AWS C
10.	14290	Lamb, Tressa	F	W	PII	AWS C
11.	13620	Culp, Erica	F	B	PII	Raines - C
12.	14561	Ritter, Michael	M	B	PII	N. Main A
13.						
14.						

SESSION: 58

TEST FORM: B

NUMBER OF HRS: 8

PEACE OFFICER STANDARDS AND TRAINING COMMISSION

COURSE: New Taser Ce

DEPARTMENT RECEIVING TRAINING: MEMPHIS POLICE DEPARTMENT

2022 IN-SERVICE TRAINING ROSTER

DATE September 16, 2022

MEMPHIS POLICE DEPARTMENT

TOTAL ATTENDANCE: 18

IBM	LAST	FIRST	SSN	RANK	ATTENDANCE					EXAM		ORDNANCE SECTION							
					MON	TUE	WED	THUR	FRI	ACAD	T.I.E.S	WLGT	REMD	FLASHL	REMD	DIMLGT	REMD	Taser Test	SHOTGI
14456	Boice	Daniel	#Name?	PII					P										
14459	Carson III	James	#Name?	PII					P										
14460	Clements	James	#Name?	PII					P										
13616	Coleman	Taylor	#Name?	PII					P										
13620	Culp	Erica	#Name?	PII					P										
14161	Fair	Coleton	#Name?	PII					P										
14635	Garland	Aron	#Name?	PII					P										
13941	Hemphill	Preston	#Name?	PII					P										
13451	House	Roderick	#Name?	PII					P										
14290	Lamb	Tressa	#Name?						P										
14192	Moore	Tony	#Name?	PII					P										
14561	Ritter Jr.	Michael	#Name?	PII					P										
14392	Rose	Jeffrey	#Name?	PII					P										
13336	Smothers	Tyler	#Name?	PII					P										
11707	Talford	Brandon	#Name?	PII					P										
13949	Tierney	Ian	#Name?	PII					P										
14405	Washington	Ashley	#Name?	PII					P										
14069	Woods Jr.	Tedetron	#Name?	PII					P										